

**Alrouf**  
**Medium intensity**  
**Aircraft**  
**Warning Light**

**ARGS-MI (TYPE-B)**  
MEDIUM INTENSITY TYPE B

# Alrouf

## Medium intensity Aircraft Warning Light ARGS-MI (TYPE-B)



### ARGS-MI (TYPE-B) Medium Intensity Type B

#### ARGS-MI (TYPE-B) medium intensity type B aviation obstruction light

its base is cast by high intensity aviation aluminum with full sealed structure.

Light source adapts high efficient CREE chip and cooperate with condensing lens that owned independent research and developing patent, offer high light intensity, long service life and other characteristics.

lamp shade adopts PC, which has strong ability of corrosion, anti-UV, anti-shock.

Controlling circuit has strong ability of lighting protection and with anti-surge protection device, it can adapt to extremely bad working environment.

This lamp with the function of adjustable code and flashing rate, user can adjust according request.

#### Features

- The shell adopts high intensity aviation aluminum to cast, with full-seal structure.
- With CREE chip, which has the specific of high light intensity, low power consumption, long service life.
- Independent designed patent condensing lens, the field angle follow the standard of FAA, ICAO.
- Lamp shade adopts tempered PC material, which has strong ability of corrosion, anti-UV, anti-shock.
- With anti-surge protection device, it can adapt to extremely bad working environment.
- Adopts advanced technology of stoving varnish, which provide excellent heating dispersion, it can reduce the volume and weight of the light.
- Offer anti-shock, lighting protection, light fastness, rain and snow resistance function.
- With over-current protection function.
- Can be customized with GPS function.

#### Dimension

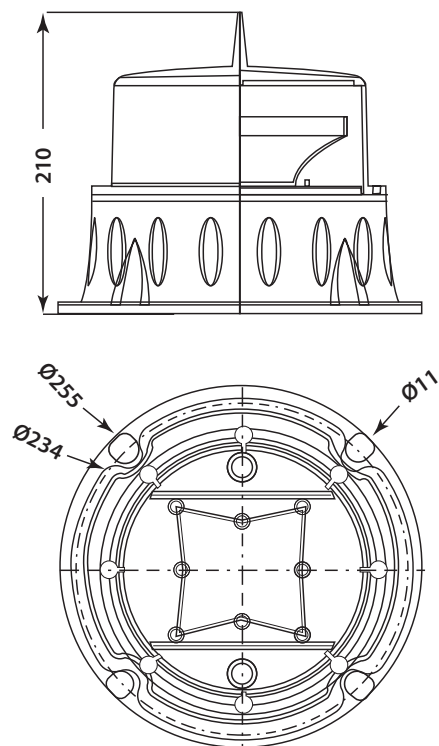

## Application

Block, Bridge, Towers, Communication tower, Chimney, Runway, Heliport, Traffic barrier, Tower cranes



## Specification

Name	Parameter
FAA Classify	L-864
Model	ARGS-MI (TYPE-B)
Power voltage	AC180V~AC264V, DC48V
Power Supply Frequency	50HZ~60HZ
Power Consumption	≤20W
Working mode	Flashing 20~40times/min
Light Intensity	2000cd ±25%
Vertical Divergence	≥3°
Horizontal Out-put	360°
Optional Emitting Light Colors	Red
Overall Size(mm)	255X255X210(mm)
Installation size	D234mm x 4 x M8
IP Protection	IP67
Optically Controlled Ambient Brightness	50/100Lux
Ambient Temperature	-50℃~70℃
Weight	3.5KG
Anti Wind Ability	80m/s